

STATE	STATE PROJECT REFERENCE NO.	SHEET NO.	TOTAL SHEETS
N.C.	DF18314.2045324	RW01	5

STATE OF NORTH CAROLINA
DIVISION OF HIGHWAYS

SURVEY CONTROL, EXISTING CENTERLINES,
RIGHT OF WAY, EASEMENTS AND PROPERTY TIES

HENDERSON COUNTY

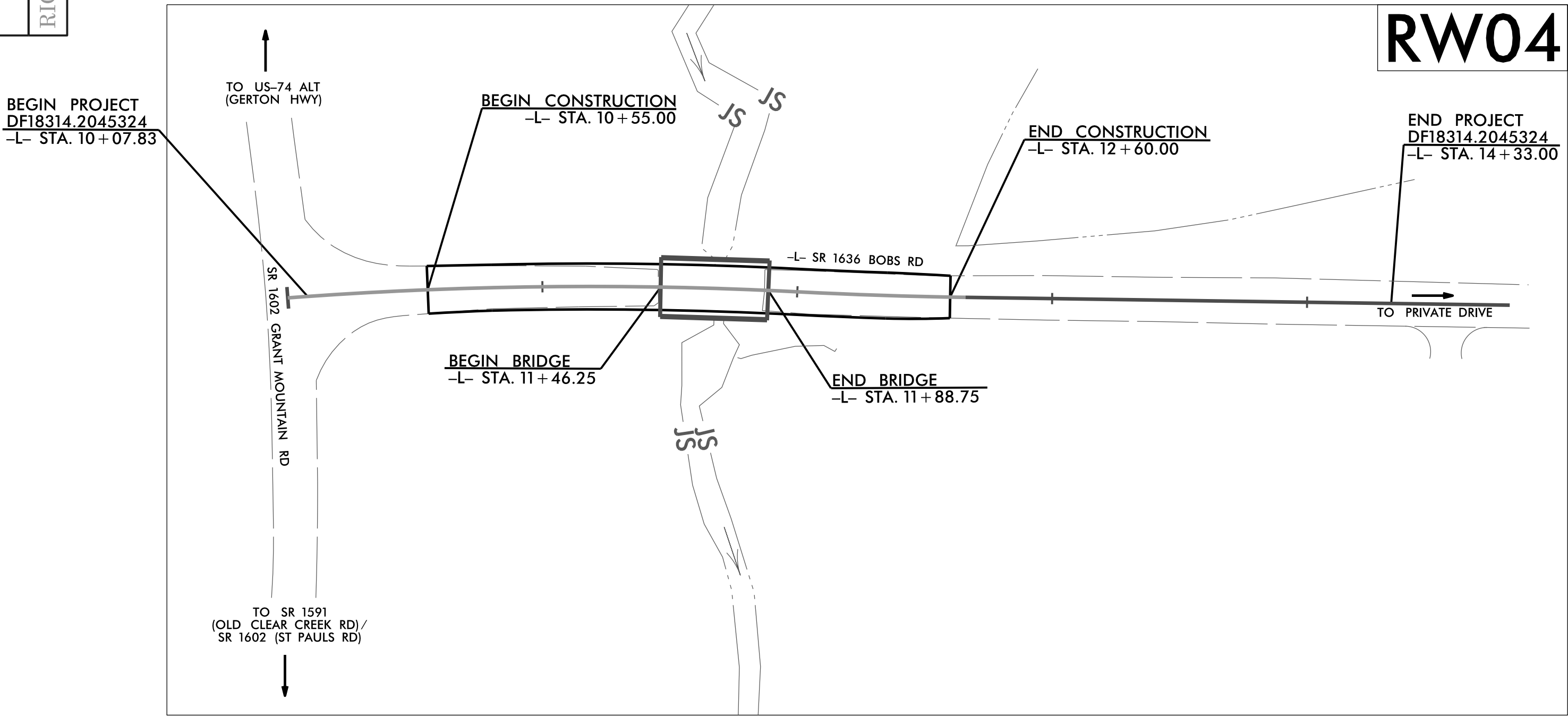
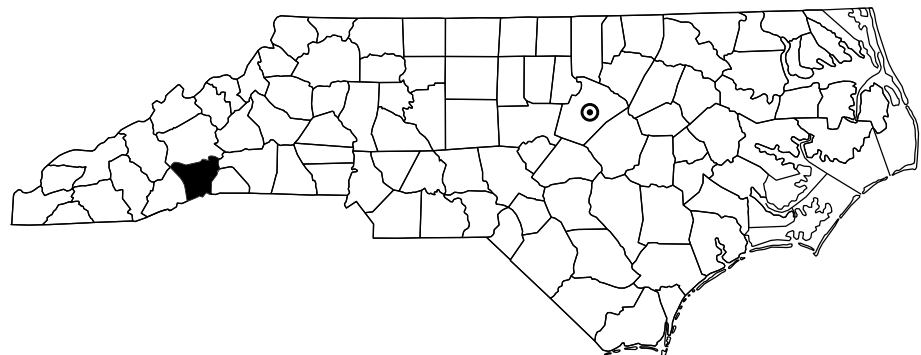
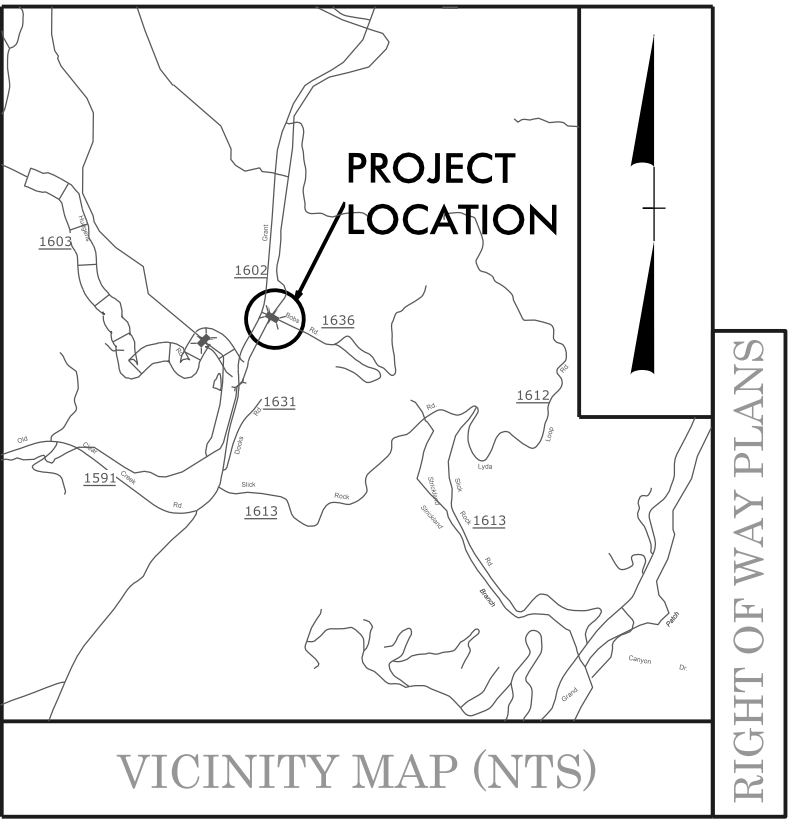

DOCUMENT NOT CONSIDERED FINAL
UNLESS ALL SIGNATURES COMPLETED

GRAPHIC SCALES



DATUM DESCRIPTION

THE LOCALIZED COORDINATE SYSTEM DEVELOPED FOR THIS PROJECT
IS BASED ON THE STATE PLANE COORDINATES ESTABLISHED BY
NCDOT FOR MONUMENT 336-1
WITH NAD83/2011 STATE PLANE GRID COORDINATES OF
NORTHING: 630243.7730' EASTING: 1010484.9640'
ELEVATION: 2333.0400'
THE AVERAGE COMBINED GRID FACTOR USED ON THIS PROJECT
(GROUND TO GRID) IS: 0.99977099
ALL LINEAR DIMENSIONS ARE LOCALIZED HORIZONTAL DISTANCES
VERTICAL DATUM USED IS NAVD 88

Prepared in the Office of:

LOCATION AND SURVEYS
DIVISION 14
122 BONNIE LANE
SYLVA, NC 28779

2024 STANDARD SPECIFICATIONS

RIGHT OF WAY DATE:
June 1, 2025

LETTING DATE:
December 9, 2025

PROFESSIONAL LAND
SURVEYOR



DocuSigned by:
Brian A. Barwatt
ASSISTANCE: 07/01/2025
SIGNATURE: DATE:

